



DT25

Track dumpers: payload 1-3 t



Tons of benefits – DT25.

The hydraulic drive of the track dumper DT25 is controlled by a joystick, and the roll bar folds down for negotiating low-clearance passageways. The low center of gravity increases stability and guarantees gradeability of up to 70%.

- The rotating driver's seat with integral "Logic" control of the direction of travel increases productivity and reduces damage to the ground.
- The one-piece engine hatch and optimal configuration of the service points make daily maintenance easy.
- The rotating driver's seat (with integral "Logic" control of the direction of travel) avoids turning the machine itself. That increases productivity through faster working cycles and also reduces damage to the ground.



Technical specifications

Operating data

Shipping weight Diesel	2,730 kg
Payload max.	2,500 kg
Skip capacity level	1,125 l
Skip capacity heaped*	1,500 l
L x W x H	3,692 x 1,550 x 2,500 mm

Engine / Motor

Engine performance Diesel	33 kW
at rpm	2,600 rpm
Travel speed Diesel	11 km/h
Gradeability	70 %

* Model with front-tipping skip

Dimensions

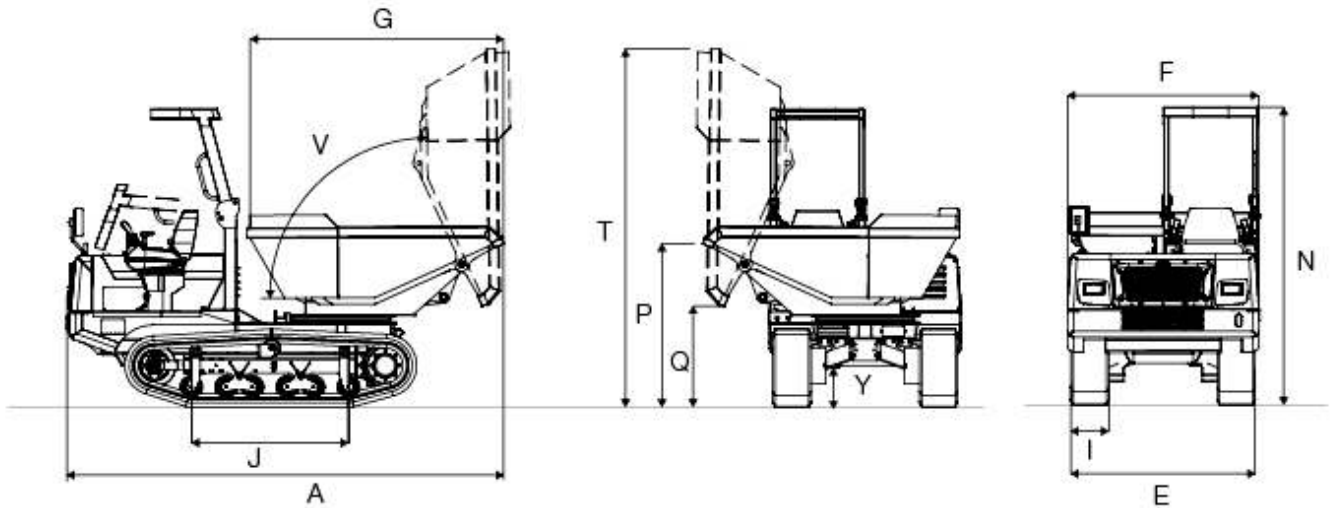

A	Length (without running board)	3,666 mm
E	Width Undercarriage	1,550 mm
F	Skip width	1,532 mm
G	Skip length	2,128 mm
I	Chain width Track	320 mm
J	Length Track	1,319 mm
N	Height over ROPS rollbar	2,500 mm
P	Height of skip front edge	1,370 mm
Q	Dumping height	850 mm
T	Height Max., skip raised	3,000 mm
V	Tip-out angle Skip dumping	90 °
Y	Ground clearance	349 mm



**WACKER
NEUSON**

Please note

that product availability can vary from country to country. It is possible that information / products may not be available in your country. More detailed information on engine power can be found in the operator's manual; the stated power may vary due to specific operating conditions.

Subject to alterations and errors excepted. Applicable also to illustrations.

Copyright © 2015 Wacker Neuson SE.